



Everything you need, on the go!

Sync Devices

Sync your Omnipod DASH™ Personal Diabetes Manager (PDM), blood glucose meter, CGM, and exercise tracker so you can see all your data in one place.

Track Lifestyle

Easily track food, medications, insulin, exercise and more to create a digital logbook.

Identify Patterns

See your blood sugar patterns and learn which is your best day and best time of day.

Get Reminders

Don't miss an important task. Set reminders to check your blood sugar, take your medications, insulin and more.

Get Support

Share your data with your care team to get the support you need in between visits.

Access Online

Review detailed reports online at www.my.glooko.com in the comfort of your home.



Create an Insulet Provided Glooko Account on the Web

Follow These Steps:

PLEASE NOTE: if your doctor has uploaded your current Omnipod® PDM to Glooko before, you already have a Glooko account. If you can't remember your login credentials, call Glooko Support at **1-800-206-6601**. They'll provide it to you and ensure that your account is connected to your doctor's.

1 Navigate to **my.glooko.com**

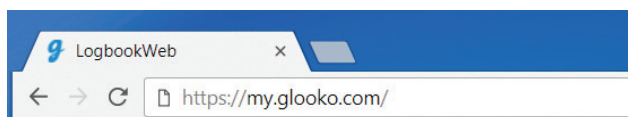

2 Click **Sign Up for Glooko Here** and fill out your information

- Enter a ProConnect Code to automatically share your Omnipod DASH™ System data with your healthcare provider

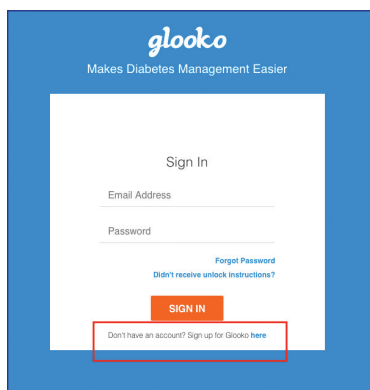

3 Select **I am an Omnipod® System user**

I am an Omnipod® System user.
 I use another type of diabetes device than the brands listed above.

Next



THAT'S IT! See next page to learn how to install the Glooko Uploader to upload data from home.

Upload Data to Your Computer



What You Need:



PC or Mac Computer



USB-A to Micro Cable



Omnipod DASH™ PDM

This cable came in your starter kit. If you cannot locate it, please order a replacement at no cost from www.myomnipod.com/podder-support/apps-data-management/glooko

Follow These Steps:

1 Install Glooko Uploader

- If you already installed the software, skip to Step 2.

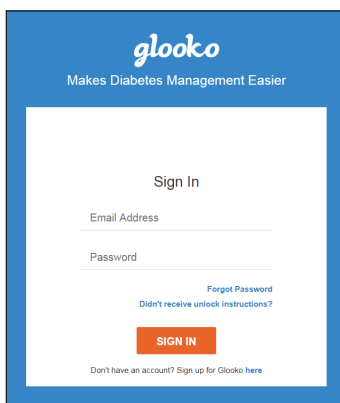

- Log into your account on **my.glooko.com**
- Choose **Settings** in the top right
- Scroll down to the bottom and click **Get Glooko Uploader**



- Choose Mac or PC
- Open the file, and follow the prompts
- Restart your computer to complete the installation

2 Upload Your Data

- Turn PDM on, and unlock it
- Plug PDM into computer

Note: Windows Media Player may open. Please close this application—it is not needed.

- Press **Export** on the PDM
- Open the Glooko Uploader software on the computer
- After upload is complete, click **View Data** on the computer

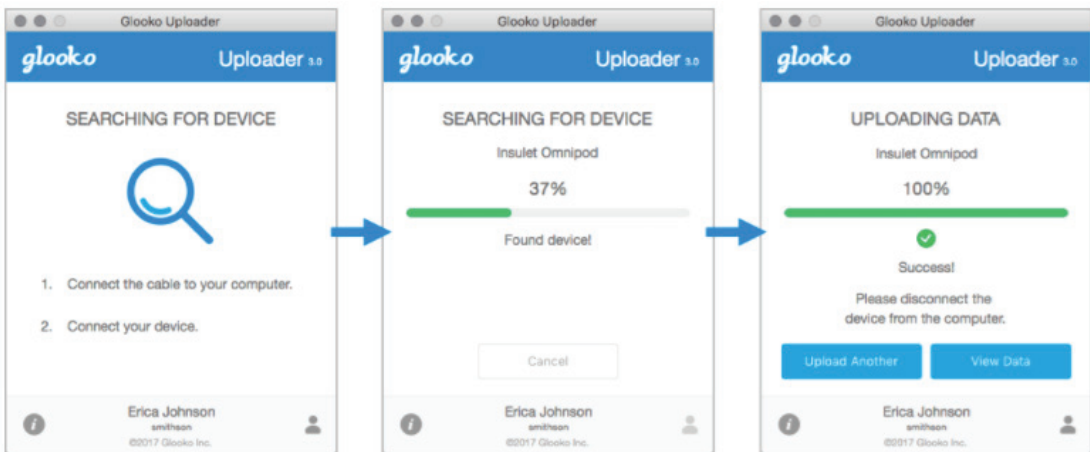

3 Share Your Data

- From **my.glooko.com**, click **Create Report** and select reports and timeframe to share.
- Click **Create** to generate PDF.
- Save or print PDF and email or fax to your Care Team.

** Note: if you entered your doctor's ProConnect Code, your healthcare provider will have access to view your PDF reports as soon as you upload.*

Tryon Medical Partners ProConnect Code: tryonmed

Insulet Provided Glooko on Your iPhone



Follow These Steps:

1 Download the App and Login

- From the App Store search for and install the Glooko Mobile App.
- Log in or create an account by filling out the requested information.



2 View Your Data

- Once you upload your data to your computer, you can view your trends and graphs on your iPhone.
- * Flip to page 3 to learn how to upload your data.*

3 Share Data with Your Care Team

- Click the **More** tab, then click **Share Reports** to email or fax reports to your care team.





Insulet Provided Glooko on Your Personal Android Smartphone

Follow These Steps:

1 Download the App and Log In

- Search for and install the Glooko Mobile App from the Google Play™ Store.
- Log in or create an account by filling out the requested information.



2 Sync and View Your Data

- Tap **Sync** from the Home Screen, and select **Omnipod DASH™ System**.
- Connect your Omnipod DASH™ PDM to your phone with a Micro-to-Micro USB cable. If you do not have one, you can order one from www.myomnipod.com/podder-support/apps-data-management/glooko.
- Follow the prompts to complete the sync.

3 Share Data with Your Care Team

- Click **Share Reports** from the side menu to email or fax reports to your care team.

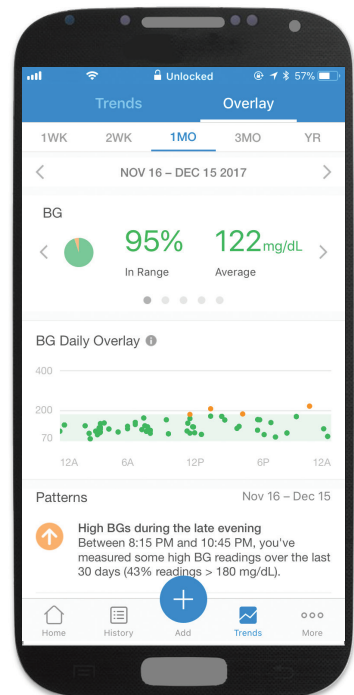
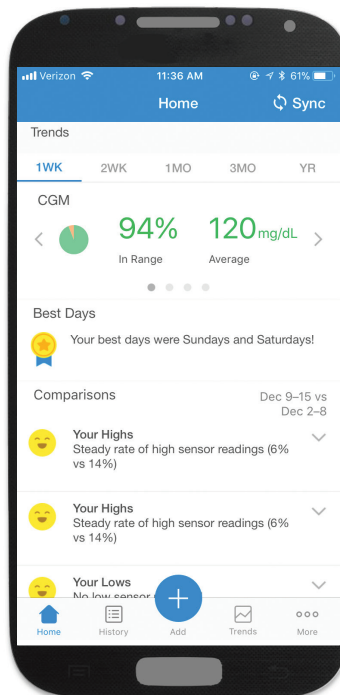

Viewing Your Reports



You can view your reports on the Glooko Mobile App or on my.glooko.com. A few great reports to get started with on **my.glooko.com** are:

1. The Logbook Report

Easily see a detailed daily view of your carbs, in and out of range BG readings, and insulin doses.

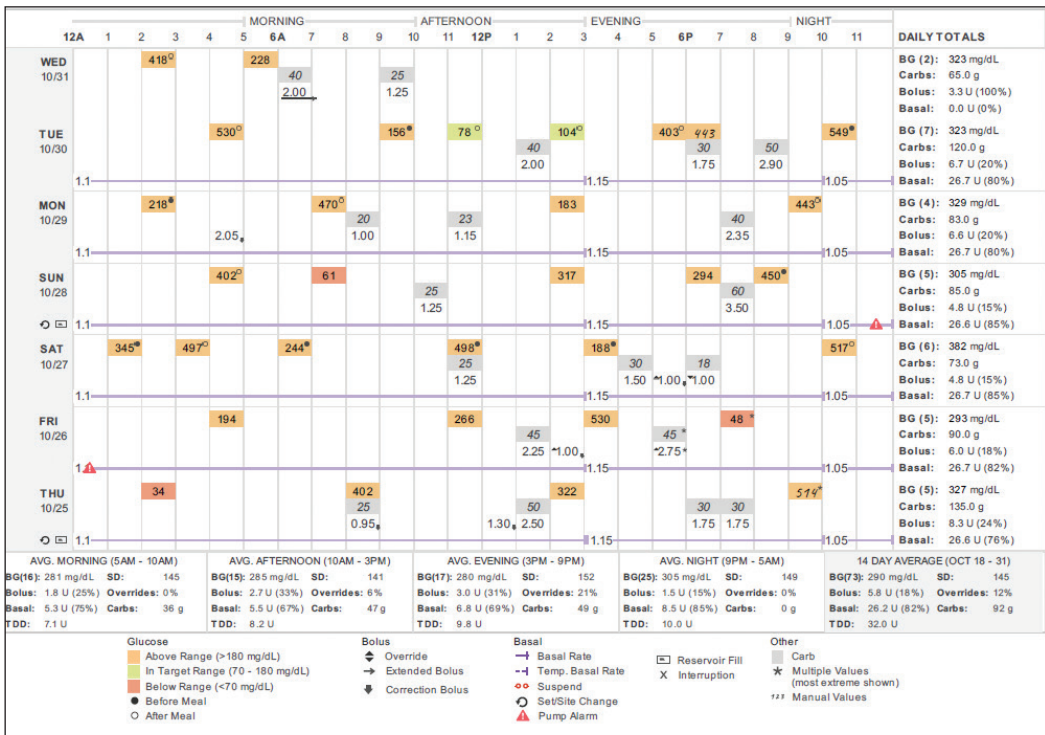

2. The Device Settings Report

When you upload your PDM to Insulet Provided Glooko, your pump settings will be saved. This report is a great resource for you and your care team to reference.

Basal Rates

Time	VALUE (u/hr)
12:00 am - 12:00 am	0.650
Total	15.60

Bolus Settings

Profile

Insulin to Carb Ratio (I:C) <table border="1"> <thead> <tr> <th>Time</th> <th>VALUE (g/U)</th> </tr> </thead> <tbody> <tr> <td>12:00 am - 12:00 am</td> <td>10</td> </tr> </tbody> </table>	Time	VALUE (g/U)	12:00 am - 12:00 am	10	Sensitivity (ISF, Correction) <table border="1"> <thead> <tr> <th>Time</th> <th>VALUE (mg/dL/U)</th> </tr> </thead> <tbody> <tr> <td>12:00 am - 12:00 am</td> <td>50</td> </tr> </tbody> </table>	Time	VALUE (mg/dL/U)	12:00 am - 12:00 am	50	Active Insulin Time <table border="1"> <thead> <tr> <th>TOTAL TIME</th> </tr> </thead> <tbody> <tr> <td>4.0 hours</td> </tr> </tbody> </table>	TOTAL TIME	4.0 hours
Time	VALUE (g/U)											
12:00 am - 12:00 am	10											
Time	VALUE (mg/dL/U)											
12:00 am - 12:00 am	50											
TOTAL TIME												
4.0 hours												
BG Target <table border="1"> <thead> <tr> <th>Time</th> <th>VALUE (mg/dL)</th> </tr> </thead> <tbody> <tr> <td>12:00 am - 12:00 am</td> <td>100</td> </tr> </tbody> </table>	Time	VALUE (mg/dL)	12:00 am - 12:00 am	100	BG Correction Threshold <table border="1"> <thead> <tr> <th>Time</th> <th>VALUE (mg/dL)</th> </tr> </thead> <tbody> <tr> <td>12:00 am - 12:00 am</td> <td>120</td> </tr> </tbody> </table>	Time	VALUE (mg/dL)	12:00 am - 12:00 am	120			
Time	VALUE (mg/dL)											
12:00 am - 12:00 am	100											
Time	VALUE (mg/dL)											
12:00 am - 12:00 am	120											

NOTE: All screen images are examples, and for instructional purposes only

If you are experiencing any issues with Glooko,
please contact Glooko Support:

Call: 1-800-206-6601 **Text:** 650-720-5310 **Email:** support@glooko.com

For more information on the Omnipod DASH™ System,
contact the Insulet Customer Care Team:

Call: 1-800.591.3455 **Visit:** www.myomnipod.com

Pod is waterproof: IPX8 (7.62 meters for up to 60 minutes). The PDM is not waterproof.

© 2018 Insulet Corporation. Omnipod and the Omnipod logo are trademarks or registered trademarks of Insulet Corporation. All rights reserved.
Glooko is a trademark of Glooko, Inc. and used with permission. All other trademarks are the property of their respective owners.
The use of third party trademarks does not constitute an endorsement or imply a relationship or other affiliation